



## EXTRASOFT CONTENITORI

design Piero Lissoni

Family of modular storage units, available in two heights with open compartments of different sizes and capacities, to be combined with Extrasoft upholstered elements or usable as freestanding low tables. Made of MDF veneered in natural or charcoal-dyed oak, with 12 mm thick tops and bases and 40 mm thick side panels. All versions are with black adjustable plastic feet. The various elements are joined together by means of hooks.

### Structure

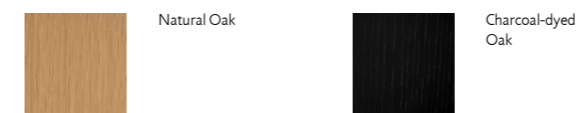

### Notes

The various elements are joined together by means of hooks to be placed in the appropriate milling, as per the instructions enclosed with the product.

Hooks for assembly with upholstered elements with standard feet in PVC.

Hooks for assembly with upholstered elements with feet with spacers.

In case of using spacers for upholstered elements, it is necessary to use the foot with height 7cm (2).

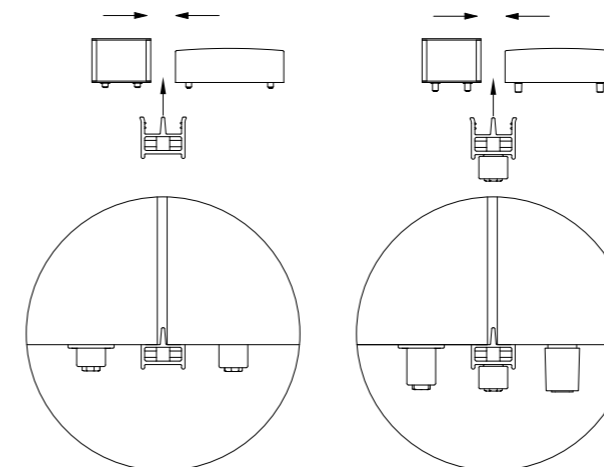

1. Foot Extrasoft  
Contentitore standard  
height

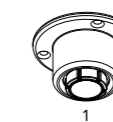

2. Foot Extrasoft  
Contentitore height  
7cm.

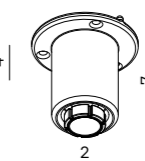

Wood is a living material; therefore, it can have slight color and dimension changes. The presence of any non-homogeneous color shades is not to be considered a defect but a quality. Please note that the direct sunlight exposure may alter the wood color; therefore, we recommend the periodic position shift of the objects placed on the furniture for the first months to avoid differences in shades between exposed and covered portions.

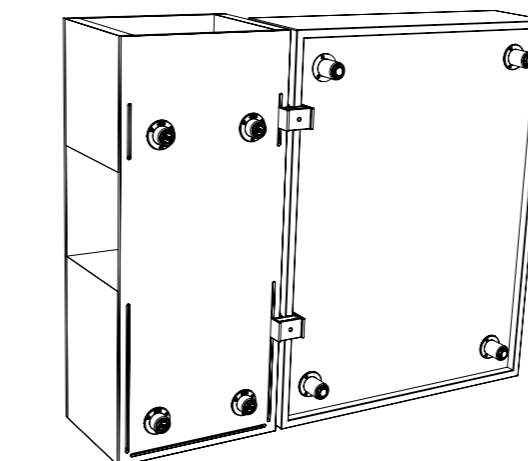

For composition with different elements, please attach a general sketch to the order.

**Technical Drawings**

Storage unit cm.94x51 h.43-33

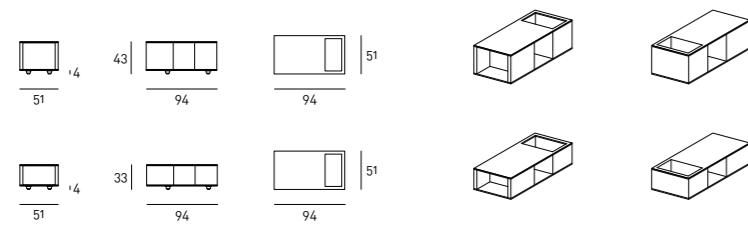

Storage unit cm.120x51 h.43-33

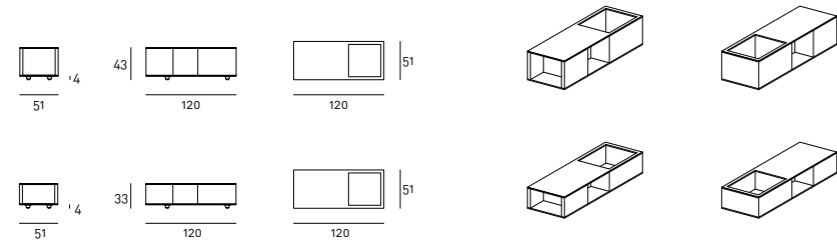

Storage unit cm.146x51 h.43-33

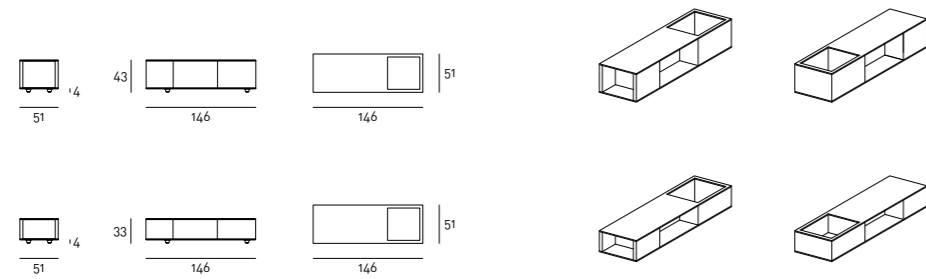

**Examples of composition**

Composition 01

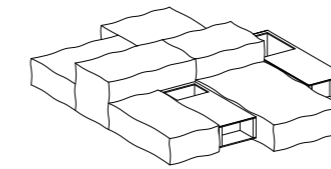
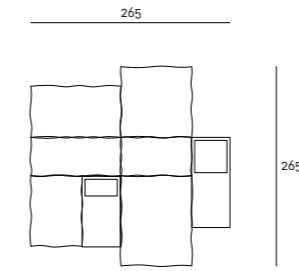

EWAE994	EWAB094A
EWAE968	EWAB094A
EWAE968	EWAB120B
EWAE968	

Composition 02

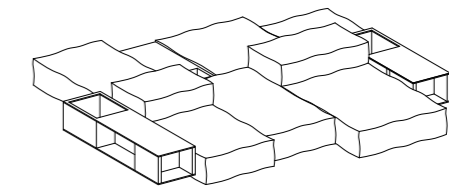
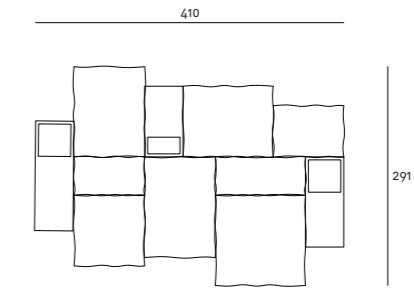

EWAE968	EWAB094A
EWAE994	EWAB120A
EWAE068	EWAB120B
EWAE120	EWAB120B

Composition 03

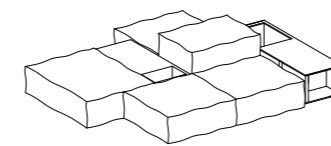

EWAE968	EWAB120B
EWAE994	EWAB120B
EWAE994	EWAB094A
EWAE134	EWAB094A

Composition 04

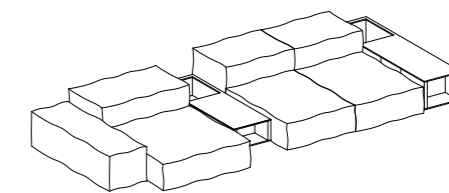
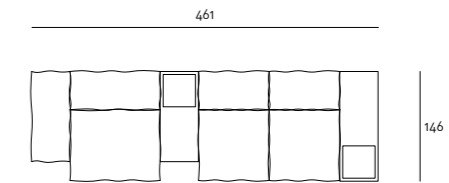

EWAE134	EWAB094B
EWAE994	EWAB094A
EWAE968	EWAB094A
EWAE994	EWAB146B
EWAE134	EWAB094A



Examples of composition  
Composition 01

624

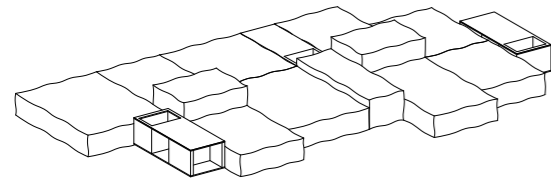
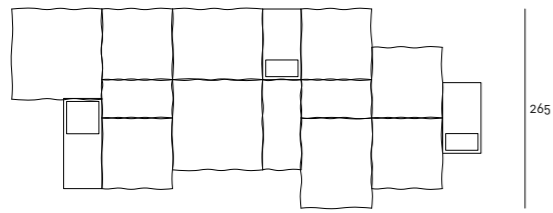

EWAE094  
EWAE134  
EWAE968  
EWAE120  
EWAE146  
EWAB120A

EWAB146A  
EWAB094B  
EWAB094B  
EWAB146B  
EWAB172B  
EWAB120B

Composition 06

461

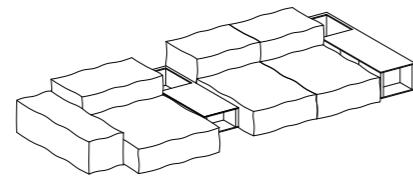
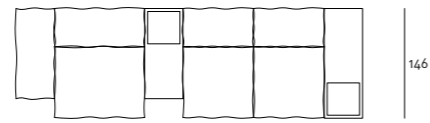

EWAE994  
EWAE968  
EWAE968  
EWAE094

EWAB094A  
EWAB094A  
EWAB120B

The commercial codes refer to the elements chosen  
in the above-proposed compositions









