

[Se non leggi correttamente questo messaggio, clicca qui](#)

LIVING
D I V A N I

The outdoor setup in Living Divani Gallery

Living Divani Gallery presents the new layout with a special focus on the outdoor scenario, a field that has become increasingly important both for contemporary design and for the Company itself.

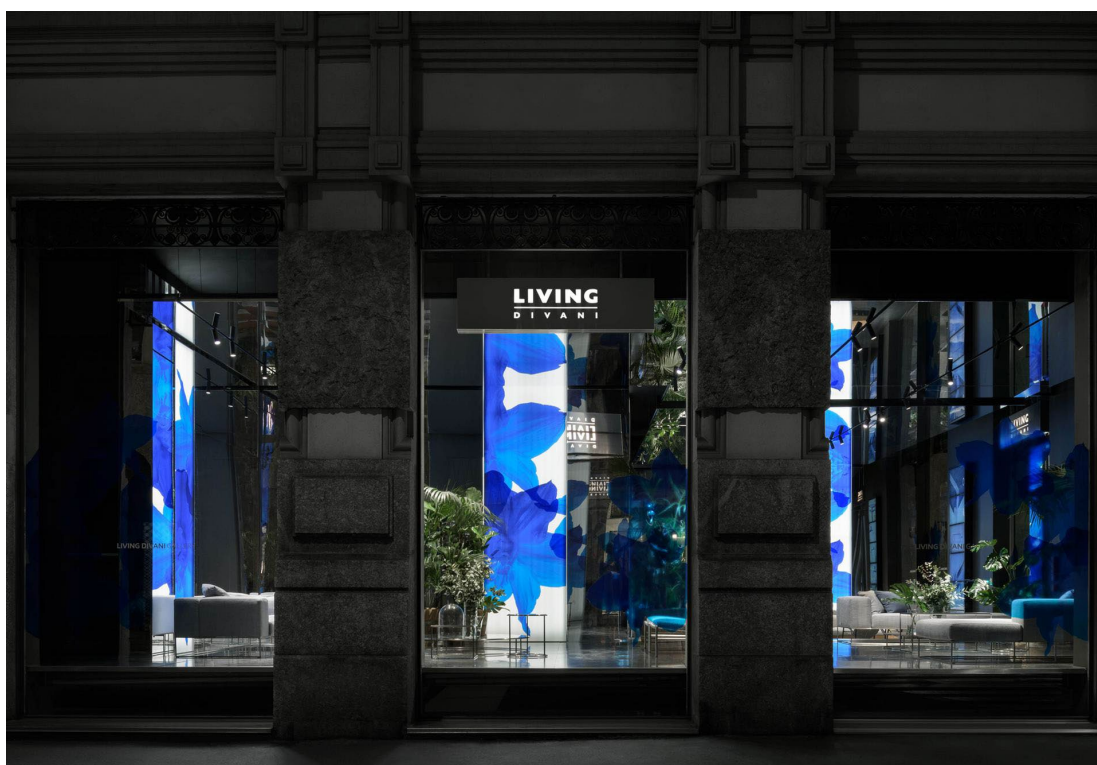

The windows between Corso Monforte and Via Visconti di Modrone turn into the stage for outdoor products that, surrounded by a floral scenography, illustrate the countless furnishing solutions for gardens and dehors thanks to upholstered furniture designed specifically for the open air: among them featuring is the new version of **Ile Club** outdoor.

Designed by *Piero Lissoni* and displayed for the first time in 2007, it has been redesigned for the outdoor space preserving its original shapes and is here proposed accompanied by **Ile** coffee tables of the homonymous family.



Products such as the **Flow** armchairs by *Shibuleru* and the **Kasbah** sofa by *David Lopez Quincoces* are recall the long, typically sunny summer days and the endless possibilities that a modular system can offer to relax en plein air.

Upholstery and seatings that blend in with nature, perfectly fitting in the outdoor spaces amidst cobalt petals and green leaves, as if emerging from the snow, put an end to the frost, evoking spring.

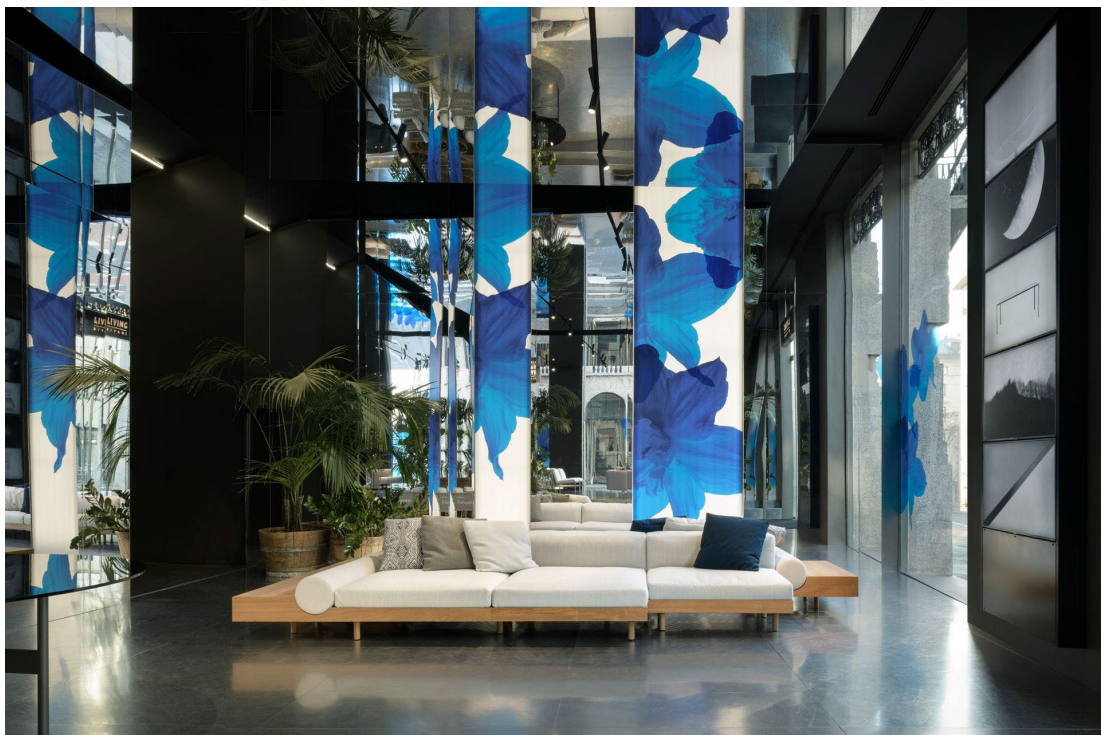

"The outdoor dimension plays an increasingly important role in the world of furniture arena. Each project is a challenge, research and innovation; each result is a new experience to live.

Living Divani Gallery allows you to enjoy the evolution of the brand by observing all its progresses and transformations within a dynamic, cultural and stimulating context." – states Carola Bestetti, CEO of Living Divani.



The exhibition continues within the internal setup display through a path with greater focus on the residential environment: from the scenes in the window, you are guided into a more intimate area, characterized by a bright skylight, which offers a sophisticated sleeping area.

The protagonists are **Sumo Bed** by *Piero Lissoni*, combined with the homonymous bench, the **Sailor** bookcase by *David Lopez Quincoces* and the **Aero D** desk by *Shibuleru*, accompanied by a living area with **Rod** sofa and **Confident "Wood"** armchairs by *Piero Lissoni*, **Tethys** coffee table, design *Oscar & Gabriele Buratti*, **Alvea** console and **Paradigma** mirror both designed by *Marco Lavit*. A precious ensemble inspired by precious rooms and declined in contract projects of major importance



A staircase leads to the lower floor, where more domestic environments offer on one side the **Clan Alta** armchairs and the **Menhir** coffee tables, the **Neowall** sofa, in the double-sided version that dialogues with **Metro²**, all designed by *Piero Lissoni* interspersed with the **Flap** and **Era Table**.

On the other side, we find a dining setting, framed by the **Sailor** bookshelf, with **Graft** table by *David Lopez Quincoces* that is surrounded by **Ticino** chairs, design *Shibuleru*; following a double living room with the **Extrasoft** sofa by *Piero Lissoni*, features the potential versatility and adaptability of the modular upholstery, interspersed with **Extrasoft Contenitori**, wooden storage units.

Sumo and **Floyd-Hi 2 System** sofas, also designed by *Piero Lissoni* and **Ark** armchairs by *David Lopez Quincoces* complete the layout.

[Press Kit](#)